

Spiral ISO 80 COLD ROOM VL

High-speed insulated door, developed with specific resistance to cold temperatures: guaranteed operation down to -25°C makes it perfectly suitable for the food and refrigeration sector.

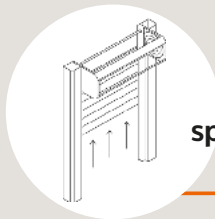

 **Thermicroll**



Opening speed up to 1,5 m/s

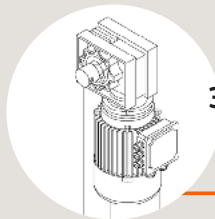

3.000.000 cycles



Inverter Control Panel
External installation

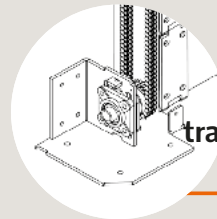

Chain transmission
Push - Pull

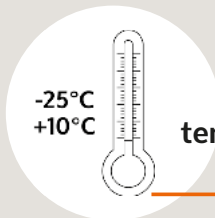

**-25°C
+10°C**
Working temperature

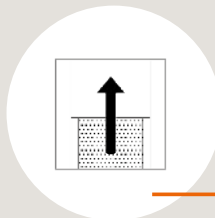

Vertical opening



Panels 80mm thick
Thermal insulation
 $\sim 1,0 \text{ W/m}^2\text{K}$



Perimeter warmed up 60 W/m



PARAMETERS	TECHNICAL OPERATIONAL DETAILS	
APPLICATION	Internal	
MAX DIMENSION *	W 3000 mm, H 3000 mm (for bigger dimension / special project, please, contact Thermicroll Technical dept.)	
OPENING SPEED *	Up to 1,5 m/s	
CLOSING SPEED *	Up to 0,5 m/s	
THERMAL TRANSMITTANCE*	~ U = 1,0 W/m ² K	
WORKING TEMPERATURE *	Tmin ≥ -25°C / Tmax ≤ +10°C (depending on the percentage of humidity in the cold room)	
STRUCTURE	Standard: Galvanised steel	Optional: Steel powder-coated in RAL Stainless steel AISI 304
DOOR BLADE 80 MM	Standard: INSULATION: aluminium OX 15um	Optional: Aluminum powder coated in RAL Powder coated steel in RAL Stainless Steel AISI 304 Stainless Steel AISI 316
GUIDES	Patented, in high density polyethylene PEHD 500000	
OPERATION	Duplex chain push- pull	
CONTROL PANEL	Inverter, installation on positive side	
POWER SUPPLY	Standard: Three phase 400 V + N + G (16 A)	Optional: single phase 230 V (10 A)
FREQUENCY	50/60 Hz	
LIMIT SWITCH	Absolute Encoder	
GEAR MOTOR	Motorised asynchronous with 110 V electric brake for intensive high-frequency use	
MANUAL OPERATION IN CASE OF POWER FAILURE *	Standard: Single chain winch	Optional: Single crank on motor (at height)
SAFETY DEVICES	Light curtain barrier	
HEATING SYSTEM	Standard: Kit for motor, brake, columns (consumption 60W/m)	Mandatory at the customer's expense: Heated floor
DURABILITY	3,000,000 cycles with periodic maintenance	

* on the door blade, installed accessories and door dimensions.

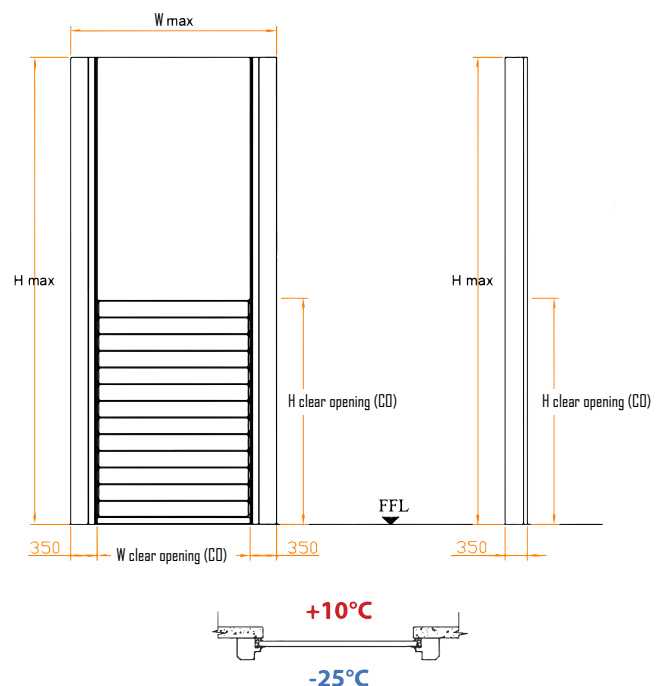
Dimensions*



Coating finishes range

-  ALUMINUM OX 15um
-  INOX
-  PAINT RAL

Thermicroll Srl reserves the right to make any changes it deems appropriate without notice. This data sheet does not constitute a contractual obligation.