

FIBREroll S

TEXTILE ROLLER FIRE CURTAIN

FIRE RESISTANCE:
EW 60-C0Sa

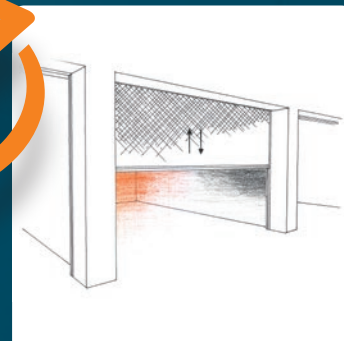

PRODUCT DESCRIPTION

- › Smoke-tight version of **FIBREroll S** textile fire curtain with **Sa classification**
- › Made of special fire-resistant textile 0.7 thick, reinforced by stainless steel wires with surface coating and aluminium reflecting coating (foil) to increase fire resistance
- › Certified dimensions: **maximum total width 3 m, maximum total height 3 m**
- › Minimum total width 1000 mm
- › Designed for face fixing or fixing between assembly (possible combination of both), fixing into concrete, masonry or steel profiles with required fire resistance
- › Standard **dimension of the curtain box** is **230 × 230 mm** (W × H)
- › Very light (curtain 3 × 3 m approx. 160 kg)
- › Controlled electrically by means of a tube drive (230 V)
- › **Control panel AOP** (Avaps Operation Panel) **including emergency closure button**
 - › System designed in accordance with EN 14637
 - › Ensures electronic control of individual curtain functions.
- › **“Fail safe”** – safe gravity closure even in the event of a power failure, status monitoring and fault evaluation (short circuit, cabling failure, undervoltage, preload,...)
- › Fire detection options: local Fire Alarm System (potential-free contact) or local detection (3 or 6 sensors depending on the closure width)
- › Contains its own back-up power source (accumulator) to prevent unwanted closing of the curtain in case of power failure, including a cyclic charging system that extends battery life
- › According to customer requirements can be supplemented with:
 - key switch, lockable button
 - optical and acoustic signalling
 - signalling of conditions to external devices
- › Closing speed is approximately 100 mm/s
- › Steel parts are made from galvanized metal, standardly powder coated in **RAL 9006** (white aluminium) or **RAL 9010** (white), alternatively, atypical coating according to the RAL sampler possible at the customer's request



CERTIFICATION

Fire curtain **FIBREroll S** has been successfully tested in fire testing centre FIRES s.r.o., classified as per EN 15269-11 and EN13501-2, assessed as per EN 13241+A2 and EN 16034 and is covered by CE certificate No. 1396-CPR-0154 (subtype of **FIBREroll**).

For more information, contact projekce@avaps.cz.

Manufacturer issues declaration of performance for individual orders in compliance with Regulation of the European Parliament and Council (EU) No. 305/2011.



TECHNICAL INFORMATION

VIEW - FIXING INTO THE OPENING (FIXED BETWEEN)

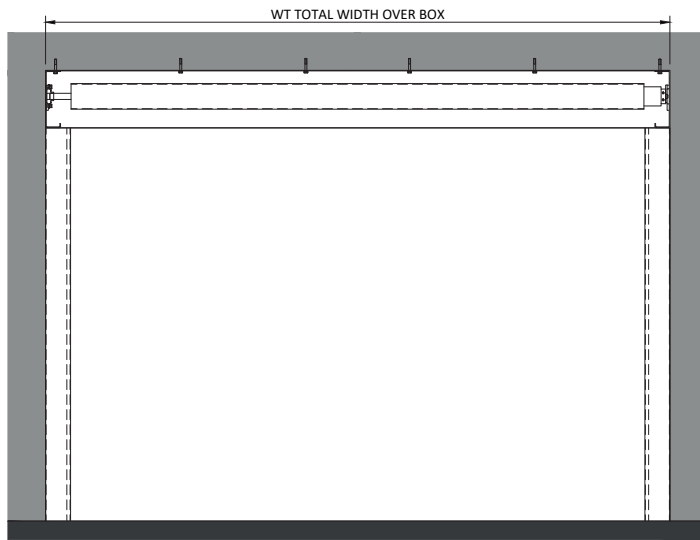

TYPICAL SECTION FIXED BETWEEN

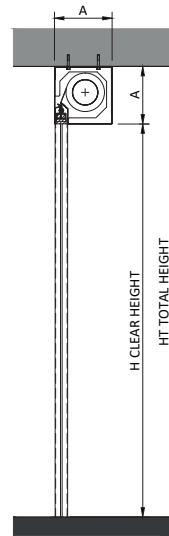

TYPICAL SECTION FACE FIXED

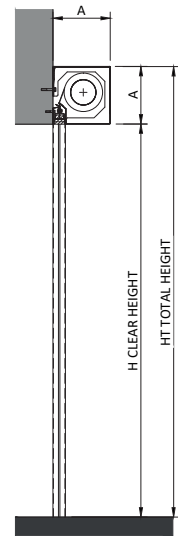

PLAN VIEW - FIXING INTO THE OPENING (FIXED BETWEEN)

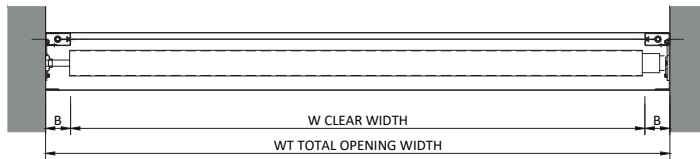

B = 100 mm IF WT ≤ 5000 mm
B = 120 mm IF WT > 5000 mm

SIDE GUIDE FIXING DETAIL

FACE BETWEEN

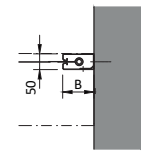

FACE FIXED

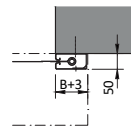

PLAN VIEW - FIXING ONTO THE OPENING (FACE FIXED)

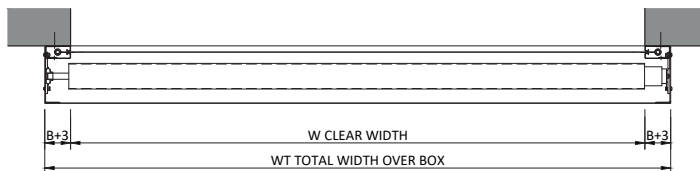

This drawing and copyright belong to Avaps s.r.o. Do not copy without Avaps s.r.o. authorisation.

MAINTENANCE AND REPAIR SERVICES

We provide professional warranty and post-warranty service and revisions according to applicable laws for all our products.

Contact: +420 777 911 780 / service@avaps.eu

